

2x12 - 2x
2x12 - 2x

LEGEND:

- EXTERIOR WALL
- 1/2" STRUCTURAL PLY WITH 10d NAILS @ 8", ONE SIDE. SHEAR RESISTANCE = 392 #/L.F.
- EXTERIOR WALL
- 3/4" STRUCTURAL PLY WITH 10d NAILS @ 8", TWO SIDE. SHEAR RESISTANCE = 784 #/L.F.
- INTERIOR WALL CONSTRUCTION
- 2x4 WOOD STUDS WITH 3/4" GYPSUM WALL BOARD EACH SIDE
- AT WET AREAS, USE CEMENT PANEL BOARDS AS PREP FOR TILER

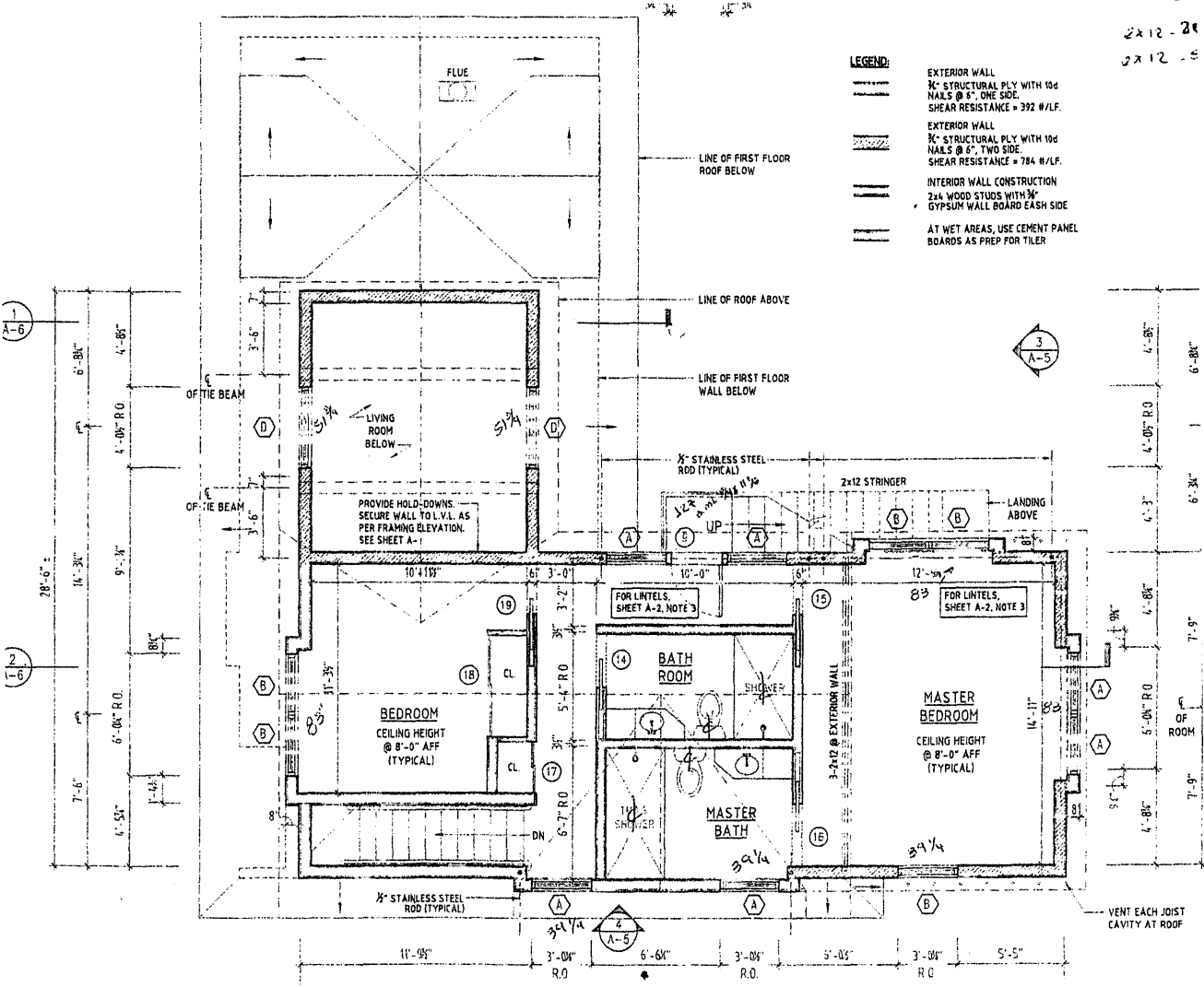

1
A-6

28'-0"
14'-3"
9'-1"
6'-0" R.O.
7'-6"
4'-5"
1'-4"
6'-0" R.O.

2
T-6

3
A-5

4'-8"
4'-0" R.O.
6'-3"
4'-3"
4'-8"
7'-9"
5'-0" R.O.
14'-11"
9'-0"
1'-8"
7'-9"
5'-5" R.O.

VENT EACH JOIST CAVITY AT ROOF

FLUE

LINE OF FIRST FLOOR ROOF BELOW

LINE OF ROOF ABOVE

LINE OF FIRST FLOOR WALL BELOW

LIVING ROOM BELOW

PROVIDE HOLD-DOWNS. SECURE WALL TO L.V.L. AS PER FRAMING ELEVATION. SEE SHEET A-1

10'-11"

3'-0"

3'-2"

3'-0"

5'-4" R.O.

3'-0"

6'-7" R.O.

1/2" STAINLESS STEEL ROD (TYPICAL)

2x12 STRINGER

LANDING ABOVE

FOR LINTELS, SHEET A-2, NOTE 3

BATH ROOM

SHOWER

STAINLESS STEEL ROD

UP

FOR LINTELS, SHEET A-2, NOTE 3

MASTER BEDROOM

CEILING HEIGHT @ 8'-0" AFF (TYPICAL)

3-7/8" @ EXTERIOR WALL

MASTER BATH

SHOWER

1/2" STAINLESS STEEL ROD (TYPICAL)

DN

3'-0" R.O.

6'-6"

3'-0" R.O.

5'-0"

3'-0" R.O.

5'-5" R.O.