

- LEGEND:**
- EXTERIOR WALL
  - 3/4" STRUCTURAL PLY WITH 10D NAILS @ 8" ONE SIDE
  - SHEAR RESISTANCE = 392 W/LF
  - EXTERIOR WALL 3/4" STRUCTURAL PLY WITH 10D NAILS @ 4" TWO SIDE
  - SHEAR RESISTANCE = 784 W/LF
  - INTERIOR WALL CONSTRUCTION
  - 2x4 WOOD STUDS WITH 5/8" GYPSUM WALL BOARD EACH SIDE
  - AT WET AREAS, USE CEMENT PANEL BOARDS AS PREP FOR TILER

- STRUCTURAL FRAMING NOTES:**
- NOTE 1:
- USE THREE (3) ROWS OF 'SIMPSON' SDS-X36 @ 16" OC (ASSEMBLY 'C'). EACH SIDE WITH FOUR (4) ROWS 3" OC AT EACH GLT V.516.
  - SEE DETAIL 3, SHEET A-8 FOR WIND HOLD DOWN AT BEARING POINTS.
  - SEE MOMENT CONNECTION AT BEARING POINTS; DETAIL 9, SHEET A-8.
- NOTE 2:
- USE THREE (3) ROWS OF 'SIMPSON' SDS-X36 @ 16" OC (ASSEMBLY 'A').
  - USE 'SIMPSON' GLT V.516 AT EACH BEARING END.
  - NAILING TO BE:
    - TOP - (4) 16d
    - FACE - (8) 16d
    - JOIST - (6) 16d
- NOTE 3:
- FOR LINTELS AT 9'-0" R.O., USE 3 - 8"x11" LVL'S WITH THREE (3) ROWS OF 'SIMPSON' SDS-X36 @ 16" O.C.

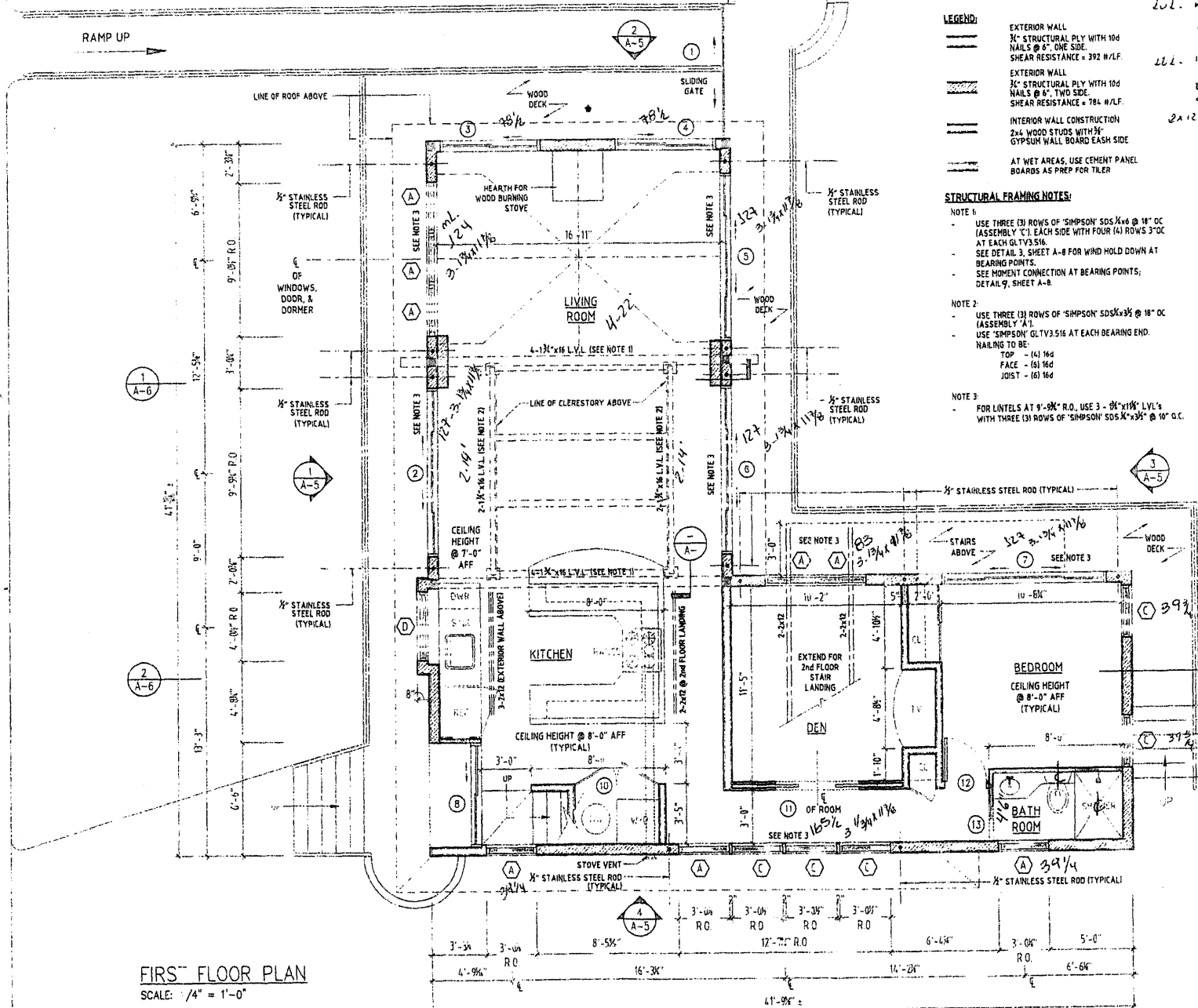

**FIRST FLOOR PLAN**  
SCALE: 1/4" = 1'-0"